

ASOT WET-LAB PLANNING

April 24, 2026

Master Planning Document

Current as of 4/14/2026

ASOT 2026 WET LAB
DAMAGE CONTROL OPHTHALMOLOGY
PGY2+ RESIDENTS, FELLOWS, & ATTENDING

April 24, 2026

Grayson W Armstrong MD MPH
Chair, ASOT Skills Transfer Lab
Vice President, ASOT

Amy Coburn MD
Chair, Annual Meeting

Boonkit Purt MD
President, ASOT

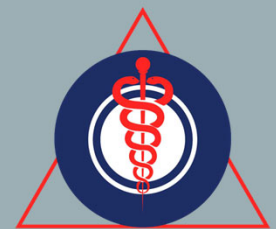

ASOT

PGY2 THROUGH ATTENDING DISASTER OPHTHO WET LAB AGENA

6:30a – 7:00a

Attendee Registration & Breakfast – *Dunn Rio Grande*
Faculty Registration & Breakfast – *MPS Classroom*

7:00a – 7:30a

Faculty Orientation – MPS Classroom – Grayson Armstrong MD

7:15a – 7:45a

Attendee Welcome & Orientation – Rio Grande – TBD

WET LAB	Zone 1	Zone 2 & 3	Orbit & Adnexa	Diagnostic & Surgical Tech Exhibit
8:00a – 9:05a	Group A	Group B	Group C	Group D
9:10a – 10:15a	Group B	Group A	Group D	Group C
10:20a – 11:25a	Group C	Group D	Group A	Group B
11:30a – 12:35p	Group D	Group C	Group B	Group A

RESIDENT & ATTENDING LAB GROUPINGS

- Group A
 - 14 participants
- Group B
 - 14 participants
- Group C
 - 14 participants
- Group D
 - 14 participants

RESIDENT & ATTENDING FACULTY LAB ASSIGNMENTS EARLY SHIFT – 8:00A-10:15A

- Zone I
 - Fasika Woreta, MD, MPH
 - Arne Viestenz, MD
 - Anja Viestenz, MD
 - Matthew Wade, MD
 - Sushank A. Bhalerao, MD
- Zone II & III
 - Touka Banaee, MD
 - Hossein Nazari, MD, PhD
 - Yewlin Chee, MD
 - Garvin Davis, MD
 - Guy Hunter, FRCOphth
- Orbit / Adnexa
 - Mary Gonzalez, MD
 - Ore-Ofe Adesina, MD
 - Imtiaz Chaudry, MD, PhD
 - Craig N. Czyz, DO
 - Seanna Grob, MD
 - Maricruz Contreras, MD
- Diagnostic & Surgical Tech Exhibit
 - Jules Winokour, MD – Anterior Segment
 - Alan Wenger, MD – Anterior Segment/Glaucoma
 - Felipe Morera, MD – Retina
 - Boonkit Purn MD - Ultrasound

RESIDENT & ATTENDING LAB FACULTY ASSIGNMENTS LATE SHIFT – 10:20A-12:35P

- Zone I
 - Jennifer Tong-Young Yu, MD, PhD
 - Rupesh Agrawal, MD
 - James Auran, MD
 - Purendra Bhasin, MD
 - Richard Blanch, MD, PhD
 - Gary LeGault, MD
 - Rahul Pandit, MD
 - Mary Charia MD*
- Zone II & III
 - Sandra Montezuma, MD
 - Ferenc Kuhn, MD, PhD
 - Carlos A. Wong Morales, MD
 - S. Natarajan, MD
 - Jose Dalma-Weiszhausz, MD
- Felipe Morera, MD
- Juan Carlos Martinez, MD
- Orbit / Adnexa
 - Ashok K. Grover, MD
 - Kirthi Koka, MD
 - Yunia Irawati, MD, PhD
 - Charles Soparker, MD, PhD
 - Michael Yen, MD
 - James Zhao, MD
- Diagnostic & Surgical Tech Exhibit
 - David Kohn, MD - Retina
 - Tomas Rybertt, MD – Anterior Segment/Glaucoma
 - Jose Romero, MD – Retina
 - Roma Patel, MD – Anterior Segment/Glaucoma
 - Grant Justin MD - Ultrasound

MITIE LAB LAYOUT

Auditorium + Breakfast
2nd floor

?Boardroom

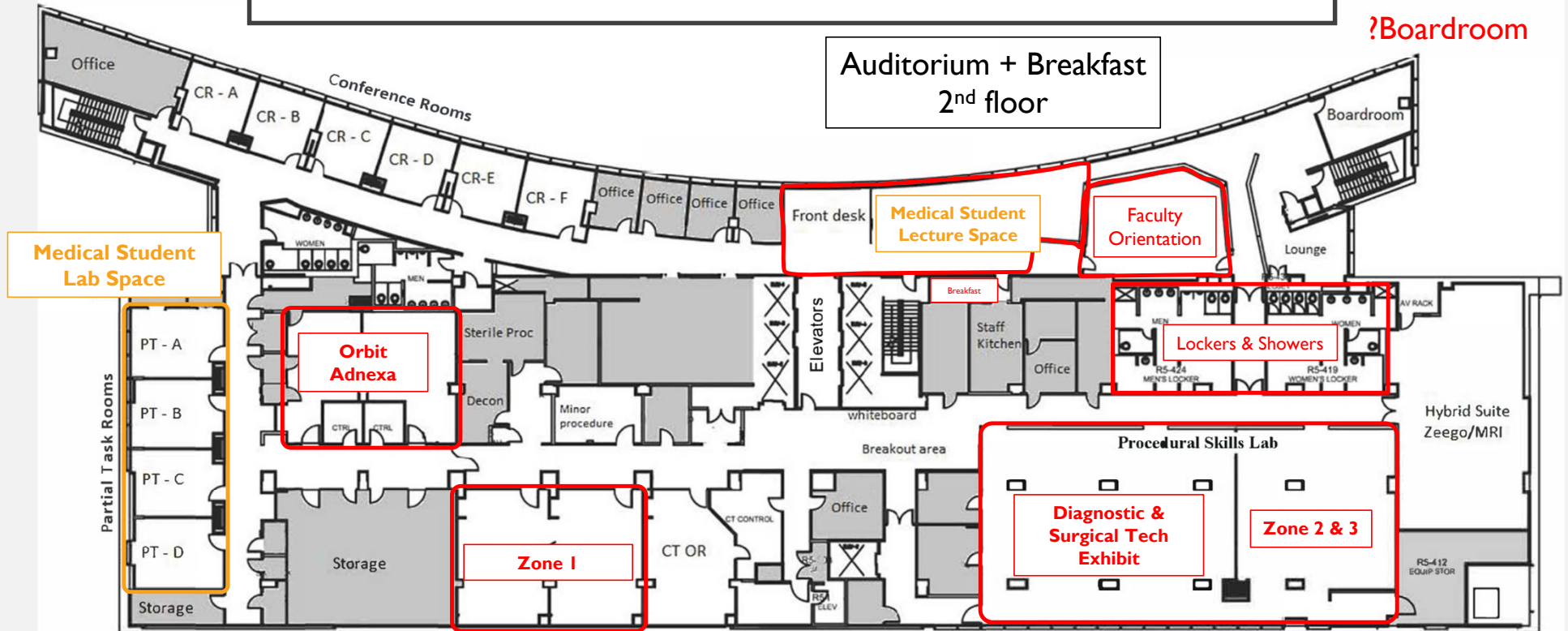

Mitie Lab

RESIDENT & ATTENDING LAB LAYOUT

ZONE I: OPEN AND CLOSED GLOBE INJURY

OR 1 & OR2

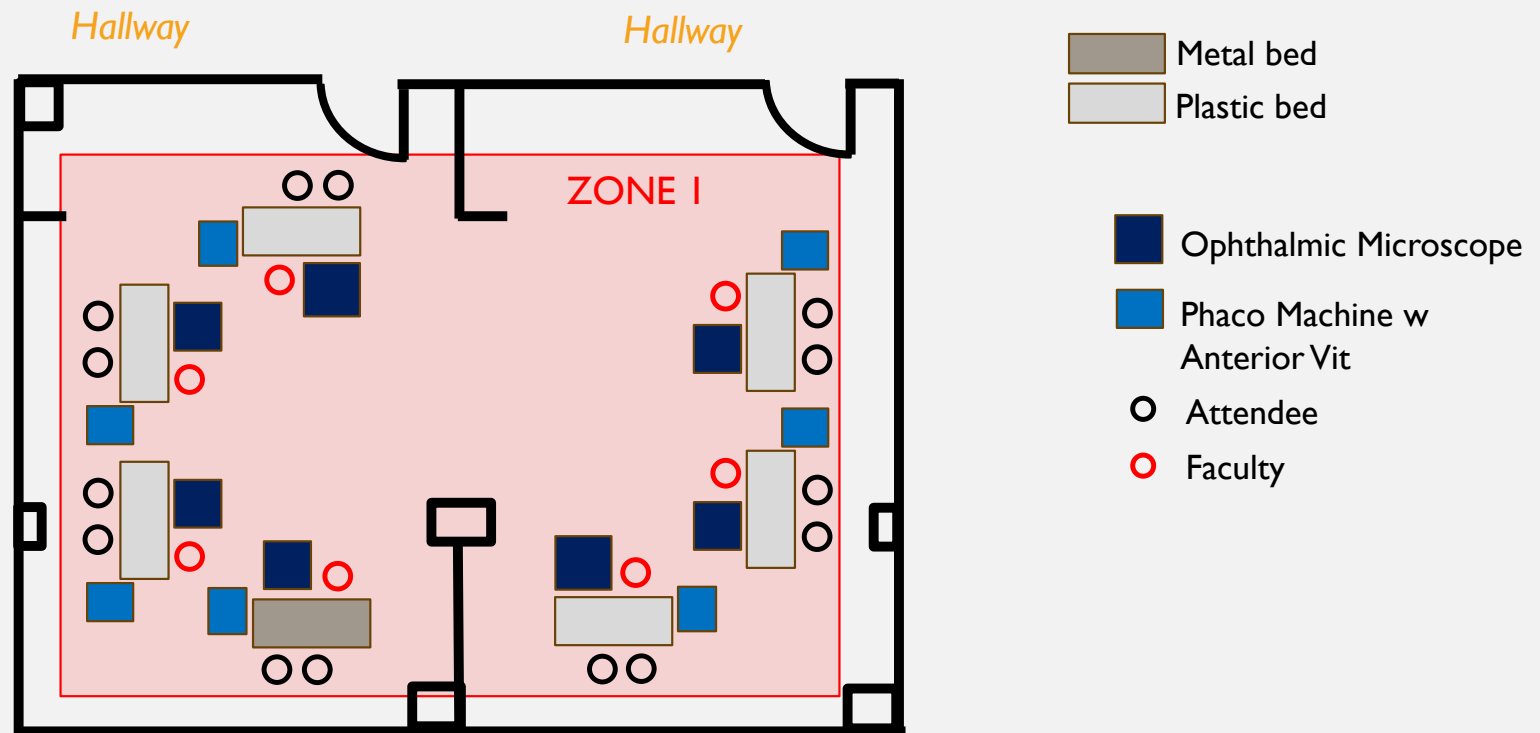

RESIDENT & ATTENDING LAB LAYOUT ORBIT & ADNEXA

SIM 1 & 2

Orbit & Adnexa

Dextenza?
Recti muscles
Others same as before

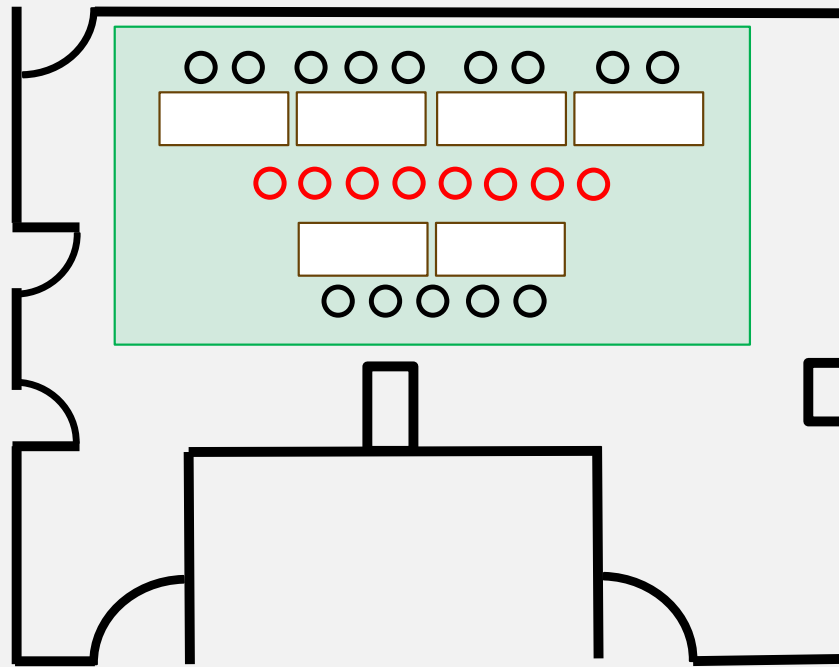

- 6ft tables
- Attendee
- Faculty

Hallway

Hallway

RESIDENT & ATTENDING LAB LAYOUT

ZONE 2&3: SCLERAL OPEN AND CLOSED GLOBE INJURY

+ DIAGNOSTIC & SURGICAL TECH EXHIBIT

Diagnostic &
Surgical Tech
Exhibit

PSL 6 + PSL 9

Hallway

Hallway

Hallway

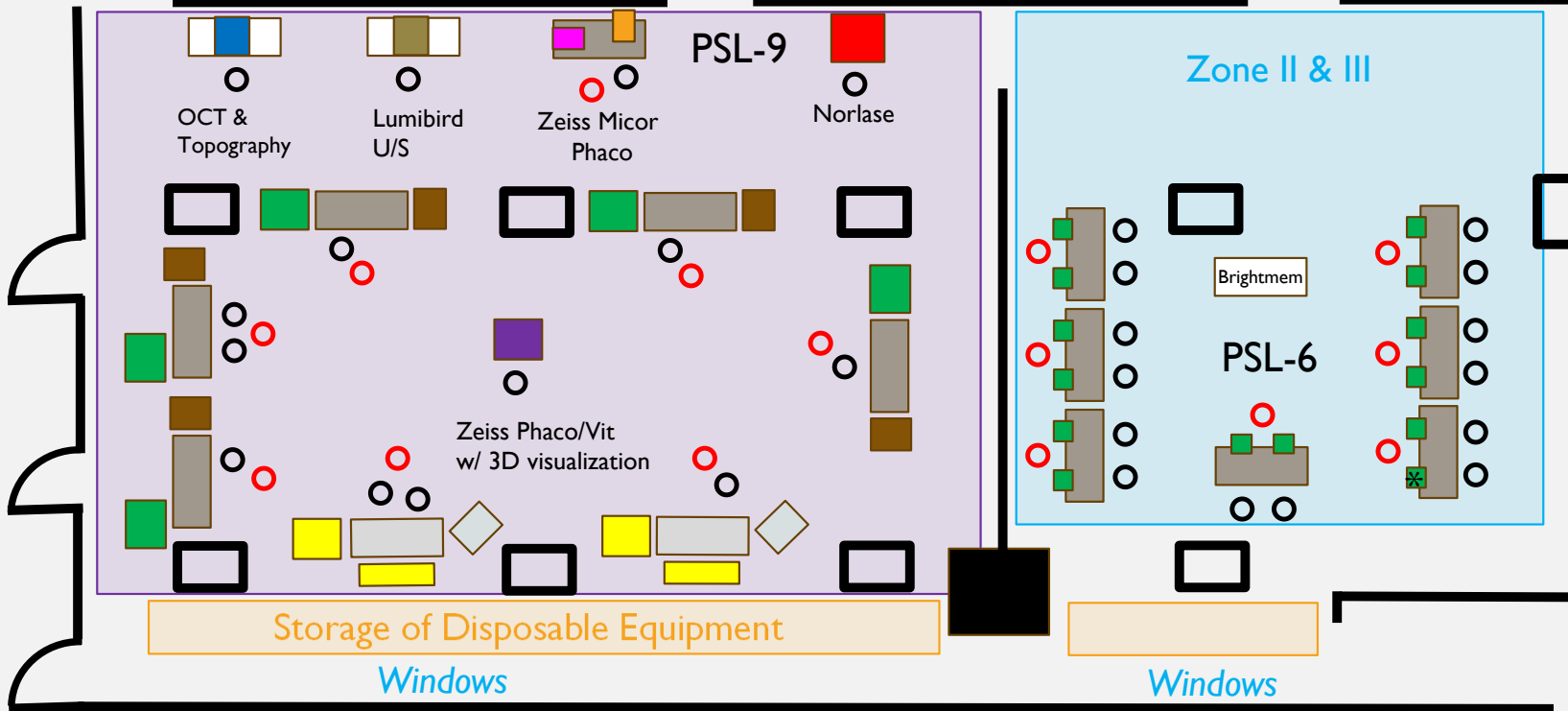

○ Attendee

○ Faculty

■ Metal bed

■ Plastic bed

■ 6ft table

■ Lumibird U/S

■ Norlase

■ HS Tabletop Microscope

■ DORC Eva Nexus

■ Tabletop Scope

■ Zeiss Artevo Microscope

+ Heads up

■ Zeiss Micor

■ Leica scope

■ B&L Stellaris

■ Heidelberg OCT

■ EyeSi

ZONE 1 SUPPLIES

Station: Corneoscleral Open Globe Repair

- Educational Objectives:
 - Gain knowledge and experience taking a history of and managing repair of eye injuries involving the cornea, anterior chamber, and the crystalline lens
 - Become competent at repair injury and understand common complications of anterior segment open-globe injury.
 - Manage complications arising from anterior segment closed globe injuries.
- Learning Objectives:
 - Suture simple and complex corneal lacerations; repair the cornea using the slip knot; manage iris and vitreous prolapse; perform lensectomy; practice anterior chamber washout
 - Optional: manage intraocular foreign body in the anterior chamber; manage a fish hook in the corneal stroma

Model Used (total needed)

- Pig eye (56)

Microscopes & Equip (total)

- Ophthalmic surgical microscopes (7)
- of zone 1 open-globe Phaco machines (7)

Reusable Supplies (per station/total needed)

- Anterior Vit Setup (1/7)
- **Kenalog (1/7)**
- **MST intraocular forceps (1/7)**
- **2.4 keratome (1/7) or other blade to make wound**
- **Paracentesis blade (1/7)**
- **30g bent cannula (1/7)**
- **Fine Needle Holder (1/7)**
- **Colibri Forceps (1/7)**
- **Cyclodialysis spatula (1/7)**
- **Iris Spatula (1/7)**
- **Vannas Scissor (1/7)**
- **Tying Forceps (straight) (1/7)**
- **Tying Forceps (Curved) (1/7)**
- Push pins (T-shaped) (3/42)
- Foam heads (1/14)

Single use supplies (total needed)

- 4"x4" gauze (lots)
- Surgical gloves (lots)
- Surgical aprons (lots)
- **10-0 nylon (56)**
- **Wek Cell spears (56 packs)**
- **Viscoelastic (120)**
- **3cc syringe (56)**
- IOFB (56)
- BSS (56)

ZONE 2 & 3 SUPPLIES

Station: Corneoscleral Open Globe Repair

- Educational Objectives:
 - Gain knowledge and experience taking a history of and managing repair of eye injuries involving the posterior segment, including the sclera and anatomic limbus
 - Become competent at repair of zone 2 and 3 open-globe injuries and understand common complications of posterior segment open-globe injury.
 - Manage complications arising from posterior segment closed globe injuries.
- Learning Objectives:
 - Suture simple and complex limbal and scleral lacerations; peritomy with relaxing incision; muscle isolation and repair; manage vitreous and uveal prolapse; tap and inject; anterior and posterior tap/culture/inject; discuss timing of potential vitrectomy and removal of intraocular foreign bodies

Model Used (total needed)

- Pig eye (56)

Microscopes (total needed)

- Surgical microscopes (14)

Reusable supplies (per station/total needed)

- **11 Blade (1/14)**
- **Scalpel handles for blades (1/14)**
- **Paracentesis blade (1/14)**
- **Colibri forceps (1/14)**
- **Blunt Wescott scissors (1/14)**
- **Fine needle holder (1/14)**
- **Tying Forceps (straight) (1/14)**
- **Tying Forceps (Curved) (1/14)**
- **Vannas scissor (1/14)**
- **Iris spatula (1/14)**
- **Cyclodialysis spatula (1/14)**
- Push pins (T-shaped) (3/42)
- Foam heads (1/14)

Single use supplies (total needed)

- Surgical gloves (lots)
- Surgical aprons (lots)
- **27g needle (56)**
- **30g needle (56)**
- **1cc syringe (56)**
- **3cc syringe (56)**
- BSS (56)
- **9-0 nylon (56)**
- **8-0 nylon (56)**
- **8-0 vicryl (56)**
- **Wek Cell spears (56 packs)**
- **Viscoelastic (120)**

ORBIT & ADNEXA SUPPLIES

Station: Orbit and Adnexal Trauma

- Educational Objectives:
 - Gain knowledge and experience taking a history of and managing repair of orbital and adnexal trauma, including marginal eyelid lacerations, orbital compartment syndrome, and canalicular lacerations.
 - Discuss the indications for and perform an enucleation.
 - Discuss the indications of and perform a tarsorrhaphy.
 - Discuss the indications for and perform a canthotomy and cantholysis.
 - Discuss indications and timing for orbital fracture repair.
- Learning Objectives:
 - Exploration to identify structures; full-thickness lid marginal laceration repair; probing of canalicular system; reapproximating tarsal plate; tarsorrhaphy; lateral canthotomy/cantholysis for orbital compartment syndrome; full thickness lid cutdown for compartment syndrome; enucleation; extraocular muscle securing and suturing
 - Practice retrobulbar block on the goat head
 - Emphasis on anatomic structures; closure in layers; ideal wound construction

Model Used (total needed)

- Goat head (56)

Microscopes (total needed)

- None

Reusable Supplies (per station/total needed)

- Barraquer Wire Eyelid Speculum (1/14)
- Castroviejo locking needle holder (1/14)
- Curved Hemostats (2/28)
- Desmarres Retractor (2/28)
- Adson Toothed Forceps (1/14)
- Enucleation (or strabismus) scissors (1/14)
- Enucleation spoon (1/14)
- Muscle Hook (2/28)
- Blunt Westcott scissors (1/14)
- 27g needle on 3cc syringe with BSS to increase retroorbital pressure (1/14)
- Eyelid pins (T-shaped) (2/28)
- Punctal dilators 00 and 0 sizing (1/14)
- 11 blade (or 14 or 15) (1/14)
- Scalpel handles for blades (1/14)

Single use supplies (total needed)

- 4" x 4" gauze (lots)
- Surgical gloves (lots)
- Surgical aprons (lots)
- 6-0 Monocryl (or Plain Gut) (56)
- 6-0 Prolene with P-3 needle (56)
- 6-0 Vicryl with S-29 needle (56)
- Minimonoka (56)
- Dextenza (56)
- BSS (56)

DIAGNOSTIC & SURGICAL TECH EXHIBIT

Station: Diagnostics & Surgical Tech Exhibit

- Educational Objectives:
 - Gain familiarity with diagnostic equipment important in pre-operative and post-operative management of patients with ocular trauma
 - Practice intraocular surgical skills using the EyeSi surgical simulator
 - Become familiar with surgical equipment used to plan and execute proper ocular trauma repair
- Learning Objectives:
 - Practice utilizing: ophthalmic ultrasound, retinal indirect laser systems, handheld phacoemulsification machines
 - Personalization and customization of: surgical microscopes, heads up displays, phacoemulsification machines, vitrectomy machines, surgical equipment, suture material, intraocular lenses

Model Used

- Pig eyes (56)
- Simuleye tumor model (1)

Microscopes & Equip (total)

- Ophthalmic surgical microscopes (7)
- Retina Vit machines (7)

Reusable supplies (per station/total needed)

- Posterior visualization (7)
- **2.4 keratome (1/7)**
- **Paracentesis blade (1/7)**
- **Cystotome (1/7)**
- **Capsulorhexis forceps (1/7)**
- **Curved tier (1/7)**
- **Straight tier (1/7)**
- **Colibri forceps (1/7)**
- **Fine needle holder (1/7)**
- **Vannas scissor (1/7)**
- Vitrectomy setup (1/7)
- Vitrectomy handpieces (1/7)
- **MVR blade (1/7)**
- **IOFB forceps (1/7)**
- **Intraocular magnet (1/7)**
- Push pins (T-shaped) (3/21)
- Foam heads (1/7)

Other equipment (total)

- Micor Phaco (1)
- 3D display (2)
- Norlase laser (1)
- Ultrasound (1)

Single use supplies (total needed)

- **Malyugin rings**
- **I-Rings**
- Surgical gloves (lots)
- Surgical aprons (lots)
- **30g bent cannula (56)**
- **Cystotome (56)**
- **Hydrodissection cannula (56)**
- **3cc syringe (56)**
- **10-0 nylon (56)**
- **8-0 vicryl (56)**
- **Viscoelastic (56)**
- BSS (56)

Haag Streit EyeSi

ASOT 2026 WET LAB SUBSPECIALTY WET LABS

April 24, 2026

Grayson W Armstrong MD MPH
Chair, ASOT Skills Transfer Lab
Vice President, ASOT

Amy Coburn MD
Chair, Annual Meeting

Boonkit Purn MD
President, ASOT



ASOT

SUBSPECIALTY RECONSTRUCTION WET LAB AGENA

**11:30p –
1:00p**

*Registration – Outside Rio Grande
Lunch & Learn – Dunn Rio & Frio*

**1:15p –
1:45p**

Faculty & Attendee Orientation – 5th fl MPS Classroom – Grayson Armstrong MD MPH

WET LAB	Glaucoma Tubes	HypHEMA Washout	Iris Repair & Yamane & Brightmem	Artificial Iris	Vitreoretinal and IOFB	Fish Hook Injury
1:50p– 3:20p	5 participants (Group A)	5 participants (Group B)	5 participants (Group C)	5 participants (Group D)	5 participants (Group E)	5 participants (Group F)
3:30p– 5:00p	5 participants (Group B)	5 participants (Group A)	5 participants (Group D)	5 participants (Group C)	5 participants (Group F)	5 participants (Group E)

SUBSPECIALTY RECONSTRUCTION WET LAB GROUPINGS

- Iris Repair & Yamane, Iris Prosthesis
 - 10 participants
- Glaucoma Tubes, Hyphema Washout
 - 10 participants
- Vitrectomy and IOFB, Fish Hook
 - 10 participants

SUBSPECIALTY RECONSTRUCTION WET LAB FACULTY ASSIGNMENTS 1:00P - 3:00P

- Iris Prosthesis
 - Mitchell P. Weikert, MD – Iris Prosthesis
 - Michael E. Snyder, MD – Iris Prosthesis
 - Bowes Hamill, MD – Iris Prosthesis
- Iris Repair & Yamane
 - Kristen Hawthorne, MD
 - Matthew Wade, MD
 - Morgan N. Fredell, MD, MBA
 - Ahmad Kheirkhah MD
- Glaucoma Tubes
 - Tara Hahn, MD
 - Won I. Kim, MD
 - Derek Mai, MD
- Ruchi Shah MD
- Hyphema Washout
 - Eileen C. Bowden, MD
 - Roma Patel, MD
 - Mary Qiu, MD
- Vitrectomy and IOFB
 - Jose Dalma-Weiszhauz, MD
 - Amin Kherani, MD
 - Ferenc Kuhn, MD, PhD
- Fish Hook
 - Hossein Nazari, MD, PhD
 - David Kohn, MD
 - Grant Justin, MD

SUBSPECIALTY RECONSTRUCTION WET LAB FACULTY ASSIGNMENTS 3:00P - 4:30P

- Iris Prosthesis
 - Mitchell P. Weikert, MD – Iris Prosthesis
 - Michael E. Snyder, MD – Iris Prosthesis
 - Bowes Hamill, MD – Iris Prosthesis
- Iris Repair & Yamane
 - Fasika Woreta, MD, MPH
 - Masih Ahmed MD
 - Morgan Fredell MD
 - Patrick Wu MD
- Glaucoma Tubes
 - Silvia Orengo-Nania, MD
 - Misha Syed, MD
 - Ian Conner, MD, PhD
- Zeynep Aktas, MD
- Hyphema Washout
 - Maria Alejandra Charria, MD
 - Grant Justin, MD
 - Alan Wenger, MD
- Vitrectomy and IOFB
 - Jose Romero, MD
 - Felipe Morera, MD
 - S. Natarajan, MD
- Fish Hook
 - Sandra Montezuma, MD
 - Boonkit Purt, MD
 - Guy Hunter, MD

RESIDENT & ATTENDING LAB LAYOUT

IRIS REPAIR, YAMANE, IRIS PROSTHESIS, FISH HOOK, VR
IOFB

PSL 6 + PSL 9

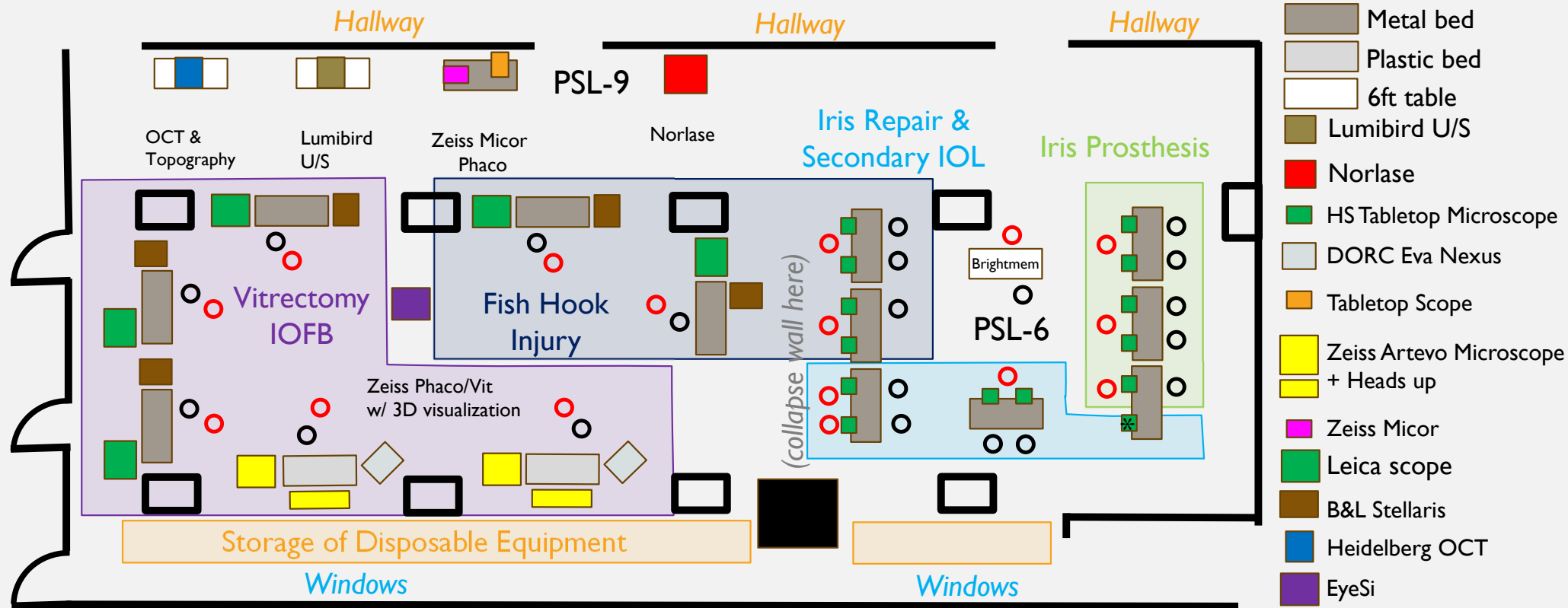

SUBSPECIALTY RECONSTRUCTION WET LAB LAYOUT GLAUCOMA

NOTE: Table top scopes + one extra table need to be brought in for afternoon

OR 1 & OR2

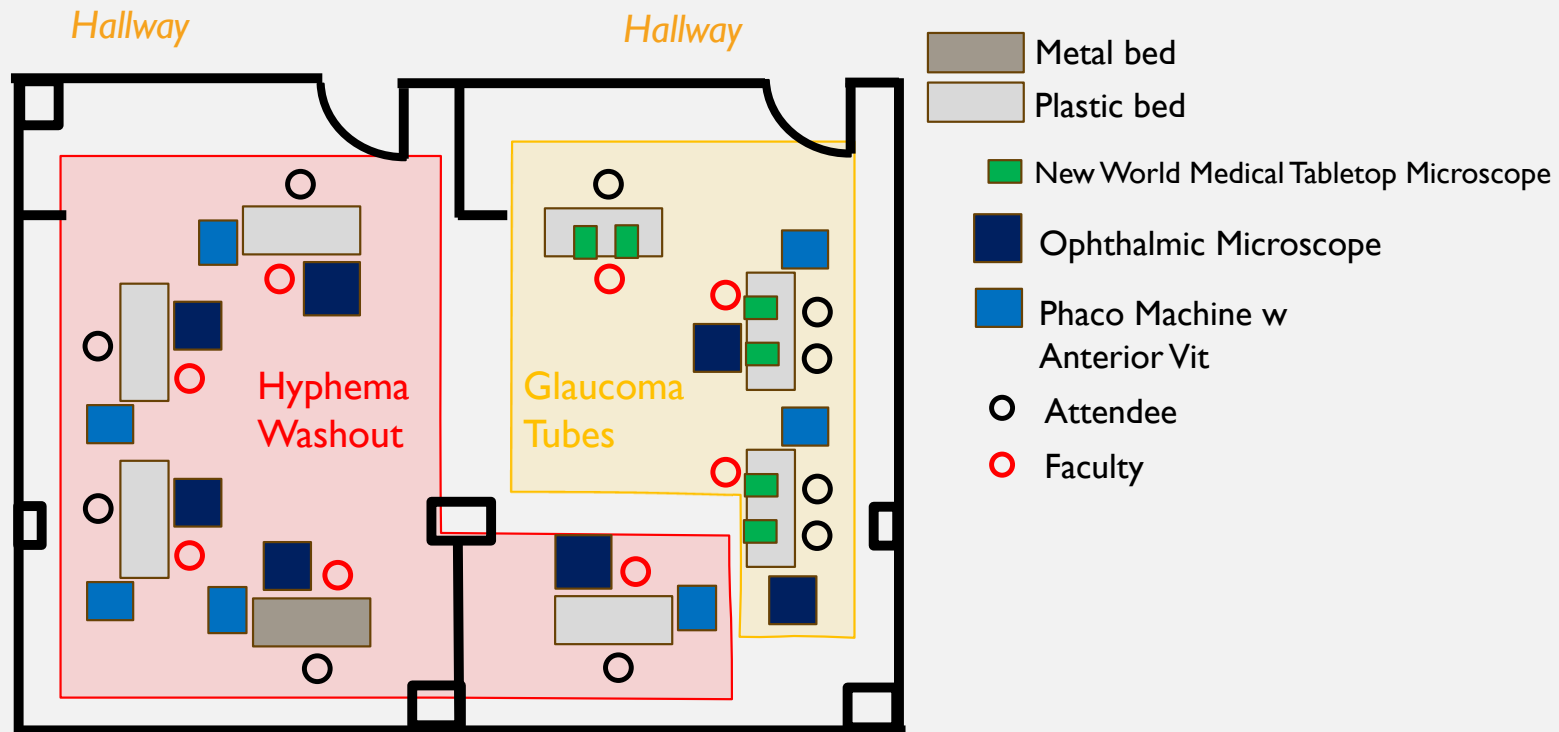

IRIS REPAIR & YAMANE SUBSPECIALTY SUPPLIES

Station: Complex Anterior Segment Lab

- Educational Objectives:
 - Practice iris repair surgical techniques using prolene suture and intraocular knot tying
 - Develop surgical skills managing secondary intraocular lens placement using the Yamane Technique for scleral lens fixation
 - Practice using the BrightMem technology
- Learning Objectives:
 - Perform iris repair using multiple techniques; cyclodialysis repair; practice placing a secondary intraocular lens using the Yamane technique

Model Used (total needed)

- **SimulEYE Artisan Anterio Seg Models (10)**
- SimulEYE 5 Base Models

Microscopes (total needed)

- Tabletop microscopes (5)

Reusable supplies (per station/total needed)

- **23g Vortex or Grieshaber MaxGrip Forceps (1/5)**
- **MST intraocular set (1/5)**
- **Kuglan hook (1/5)**
- **Fine Needle Holder (1/5)**
- **Colibri forceps (1/5)**
- **Paracentesis blade (1/5)**
- **2.4mm keratome (1/5)**
- **Angle tier (1/5)**
- **Straight tier (1/5)**
- **Vannas scissor (1/5)**
- **Low temp cautery (1/5)**
- **Toric corneal marker (1/5)**
- **Zeiss lens injectors (1/5)**

Single use supplies (total needed)

- Surgical gloves (lots)
- Surgical aprons (lots)
- **Zeiss IOL cartridge (1/10)**
- **10-0 Prolene CTC-6L (2/20)**
- **27g needle (1/10)**
- **Viscoelastic (2/20)**
- **30g TSK needles (2/20)**
- **1cc syringe w leur lock (1/10)**
- **Wek Cell spears (20 packs)**
- BSS

IOLs

- **CT Lucia 602 (10)**

Brightmem

- Setup on table

IRIS PROSTHESIS SUBSPECIALTY SUPPLIES

Station: Complex Anterior Segment Lab

- Educational Objectives:
 - Discuss indications for an surgical options for iris prosthesis placement
 - Practice iris prosthesis surgical techniques
- Learning Objectives:
 - Prepare and implant an iris prosthesis device

Model Used (total needed)

- **SimulEYE** Iris Prosthesis Scleral Fix ant seg models (10)
- SimulEYE Iris Prosthesis ITB ant seg models (10)
- SimulEYE base model w BAG (5)
- SimulEYE base model w/o BAG (5)

Microscopes (total needed)

- Tabletop microscopes (5)

Reusable supplies (per station/total needed)

- **23g or 25g Vortex or Grieshaber MaxGrip Forceps (1/5)**
- **Fine needle driver (1/5)**
- **Colibri forceps (1/5)**
- **Paracentesis blade (1/5)**
- **2.4mm keratome (1/5)**
- **Cyclodialysis spatula or kuglen hook (1/5)**
- **Angled tier (1/5)**
- **Straight tier (1/5)**
- **9.5mm or 10mm trephine blade (1/5)**
- **Trephination centering guide EPSILON (1/5)**
- **Busin glide 5mm large (1/5)**
- **Vannas scissor (1/5)**

Single use supplies (total needed)

- Surgical gloves (lots)
- Surgical aprons (lots)
- **Gortex CV-8 sutures (30)**
- **B+L Injector 100 or Starr ICL injector or other injector (1/10)**
- **Iris VEO Implant (1/10)**
- **Cohesive OVD (3/30)**
- **Wek Cell spears (10 packs)**
- BSS

HYPHEMA WASHOUT SUBSPECIALTY SUPPLIES

Station: Hyphema Washout Lab

- Educational Objectives:
 - Gain knowledge and experience managing traumatic hyphema, including indications for washout and surgical techniques
- Learning Objectives:
 - Hyphema and anterior chamber washout

Model Used (total needed)

- Pig Eyes (10)

Microscopes (total needed)

- Ophthalmic surgical microscopes (5)
- Phaco machines (5)

Reusable supplies (per station/total needed)

- Anterior vit setup (1/5)
- **2.4 keratome (1/5)**
- **Paracentesis blade (1/5)**
- **Colibri forceps (1/5)**
- **Fine needle holder (1/5)**
- **Straight tier (1/5)**
- **Curved Tier (1/5)**
- **Vannas scissor (1/5)**

Single use supplies (total needed)

- Surgical gloves (lots)
- Surgical aprons (lots)
- **10-0 nylon (10)**
- **Wek Cell spears (10 packs)**
- **Viscoelastic (20)**
- Red dye and KY jelly versus blood for clots (likely expired blood)
- BSS

GLAUCOMA TUBES SUBSPECIALTY SUPPLIES

Station: Glaucoma Tube Lab

- Educational Objectives:
 - Gain knowledge and experience managing glaucoma tubes to manage traumatic glaucoma
- Learning Objectives:
 - Tube placement; durysta and dextenza placement

Model Used (total needed)

- Pig Eyes (10)

Microscopes (total needed)

- Ophthalmic surgical microscopes (5)

Reusable supplies (per station/total needed)

- 2.4 keratome (1/5)
- Paracentesis blade (1/5)
- Colibri forceps (1/5)
- Fine needle holder (1/5)
- Straight tier (1/5)
- Curved Tier (1/5)
- Vannas scissor (1/5)
- Durysta model (1?)
- Dextenza model (1?)

Single use supplies (total needed)

- Surgical gloves (lots)
- Surgical aprons (lots)
- 27g needle (10)
- 10-0 nylon (10)
- 6-0 prolene (10)
- 8-0 vicryl (10)
- Wek Cell spears (10 packs)
- Viscoelastic (20)
- Ahmed FP7 (10)
- Ahmed ClearPath ST (10)
- BSS

Make this match New World Medical

VR/IOFB SUBSPECIALTY SUPPLIES

Station: VR and IOFB in Trauma

- Educational Objectives:
 - Gain knowledge and experience managing complex intraocular foreign body removal from the vitreous cavity
 - Practice intraocular foreign body removal techniques using the EyeSi surgical simulator
- Learning Objectives:
 - Pars plana vitrectomy; intraocular foreign body removal from vitreous cavity; fish hook removal from posterior segment
 - Optional: ozurdex, xipire, and Yutiq injection

Model Used (total needed)

- **SimuleYE** VR VH IOFB models (10)

Microscopes (total needed)

- Ophthalmic surgical microscopes (5)
- Posterior seg viewing systems (5)
- VR machines (5)

Reusable supplies (per station/total needed)

- Vit Pack Setup (1/5)
- **2.4 keratome (1/5)**
- **Paracentesis blade (1/5)**
- **Colibri forceps (1/5)**
- **Fine needle holder (1/5)**
- **Straight tier (1/5)**
- **Curved Tier (1/5)**
- **Vannas scissor (1/5)**
- **Iris Spatula (1/5)**
- **Cyclodialysis spatula (1/5)**
- **Kenalog (1/5)**
- **MVR Blade (1/5)**
- **Synergetics IOFB forceps (1/5)**
- **Rare-Earth Intraocular magnet (1/5)**
- **Retrieving Basket or Loop (1/5)**
- **Backflush Flute Needle (1/5)**
- **Soft tip cannula (1/5)**
- **Light pipe (1/5)**
- **Chandelier light (1/5)**
- Silicone oil injector (1/5)

Support Materials

- Perfluorocarbon liquid
- Silicone oil (various viscosities)

Single use supplies (total needed)

- Surgical gloves (lots)
- Surgical aprons (lots)
- **6-0 or 7-0 vicryl (10)**
- Ozurdex injection (10)
- Xipire injection (10)
- Yutiq (10)
- **Wekcells (10 packs)**
- BB (10)
- Glass shards (10)
- BSS
- Viscoelastic (20)

Optional

- Intraocular OCT

Haag Streit EyeSi

FISH HOOK INJURY SUBSPECIALTY SUPPLIES

Station: Fish hook injuries

- Educational Objectives:
 - Gain knowledge and experience managing fish hook injury to the globe, including the limbus, posterior segment and retina while minimizing collateral damage
- Learning Objectives:
 - Fish hook removal from anterior and posterior segment

Model Used (total needed)

- Pig Eye (10)

Microscopes (total needed)

- Ophthalmic surgical microscopes (5)

Reusable supplies (per station/total needed)

- **Protective Eyewear (10)**
- **Small wire cutters or heavy scissors (1/5)**
- **Locking Needle Driver or Pliers (1/5)**
- **Foreign body forceps (serrated or diamond dusted) (1/5)**
- **Colibri forceps (1/5)**
- **Blunt Wescott Scissors (1/5)**
- **Vannas scissors (1/5)**
- **Castroviejo needle driver (1/5)**
- **Fine needle holder (1/5)**
- **Calipers (1/5)**

Single use supplies (total needed)

- **Fish hooks (50)**
- Surgical gloves (lots)
- Surgical aprons (lots)
- **9-0 nylon (10)**
- **10-0 nylon (10)**
- **6-0 or 7-0 vicryl (10)**
- IV tubing or silicone sleeve protectors
- **Wekcells (10 packs)**
- BSS
- **23g needle (10)**
- **25g needle (10)**

ASOT 2026 WET LAB
EARLY CAREER WET LAB
MEDICAL STUDENTS & PGY1 RESIDENTS

April 24, 2026

Grayson W Armstrong MD MPH
Chair, ASOT Skills Transfer Lab
Vice President, ASOT

Amy Coburn MD
Chair, Annual Meeting

Boonkit Purn MD
President, ASOT

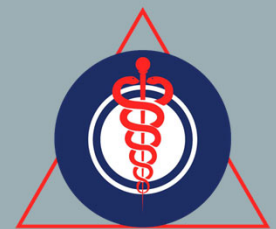

ASOT

STUDENT & PGYI LAB AGENA

6:30a – 8:00a

*Faculty Registration & Breakfast – 5th fl MITIE Lab
Attendee Registration & Breakfast – Rio Grande*

8:00a – 8:30a

*Attendee Orientation – Dunn – Faculty TBD
Faculty Orientation – MPS Classroom - Grayson Armstrong MD*

WET LAB	Corneal Suturing	Skin Suturing	Corneal FB Removal	Trauma Lectures
8:45a – 9:15a	Group A & B	Group C	Group D	Groups E,F,G,H + Snacks
9:15a – 9:45a		Group D	Group C	
9:45a – 10:15a	Group C & D	Group A	Group B	
10:15a – 10:45a		Group B	Group A	
10:45a – 11:15a	Group E & F	Group G	Group H	Groups A,B,C,D + Snacks
11:15a – 11:45a		Group H	Group G	
11:45a – 12:15p	Group G & H	Group E	Group F	
12:15p – 12:45p		Group F	Group E	
12:45p	<i>Lunch & Learn – Dunn Rio & Frio</i>			

STUDENT LAB GROUPINGS

8:00AM – 11:50AM

- Group A
 - 4 participants
- Group B
 - 4 participants
- Group C
 - 4 participants
- Group D
 - 4 participants
- Group E
 - 4 participants
- Group F
 - 4 participants
- Group G
 - 4 participants
- Group H
 - 4 participants

STUDENT LAB
FACULTY ASSIGNMENTS
8:30A – 10:30A

- Corneal FB Removal
 - Amy Coburn, MD
- Corneal suturing
 - Chris Rapuano, MD
 - Kanwal Matharu, MD
- Skin Suturing
 - Eileen Bowden, MD
 - Michael Yen, MD
- Trauma Lecture
 - Ankoor Shah, MD

STUDENT LAB
FACULTY ASSIGNMENTS
10:30A – 12:30P

- Corneal FB Removal
 - Marguerite Weinert, MD
- Corneal suturing
 - Misha Syed, MD
 - Maria Alejandra Charria, MD
- Skin Suturing
 - Mona Hussein, MD
- Trauma Lecture
 - Ankoor Shah, MD

MITIE LAB LAYOUT

Auditorium + Breakfast
2nd floor

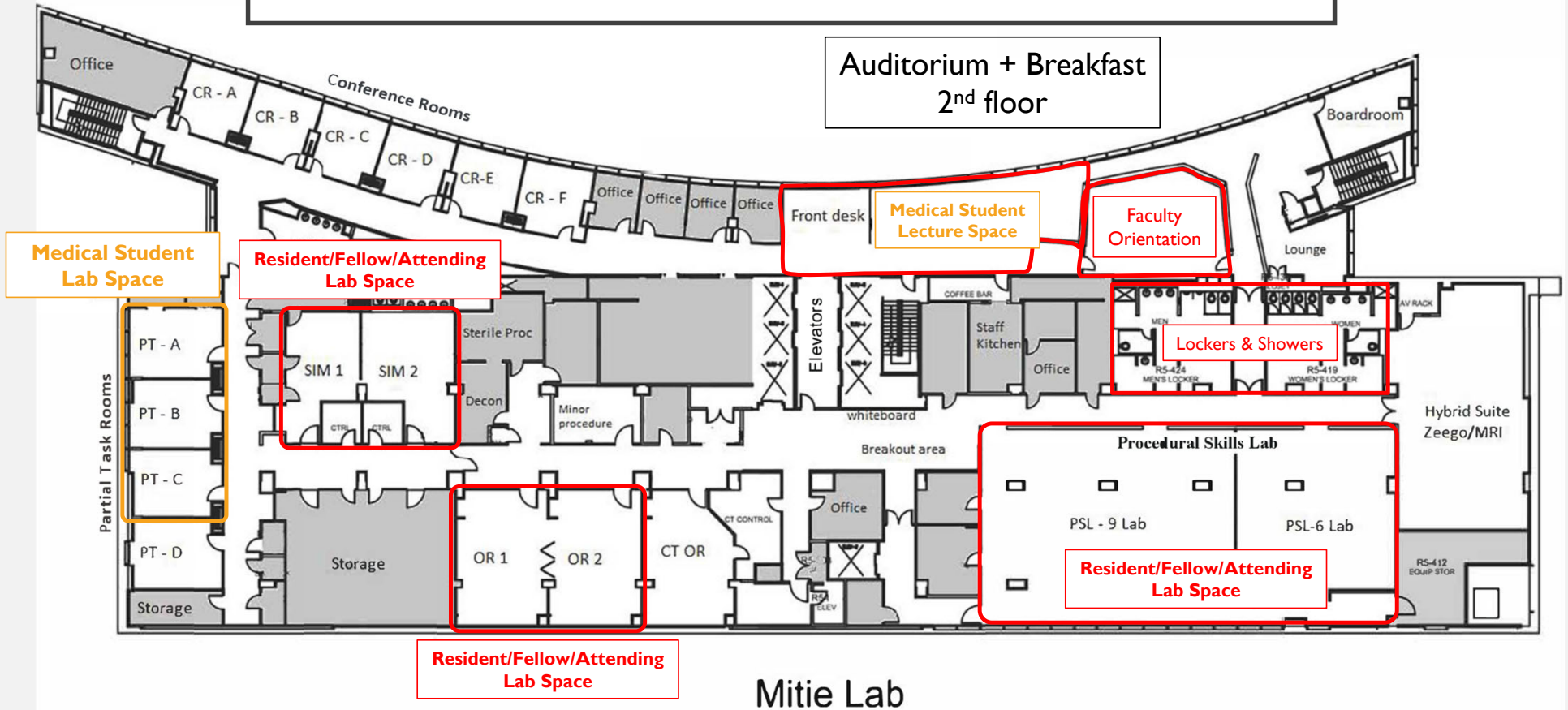

Mitie Lab

STUDENT LAB LAYOUT

Partial Task Rooms A through C

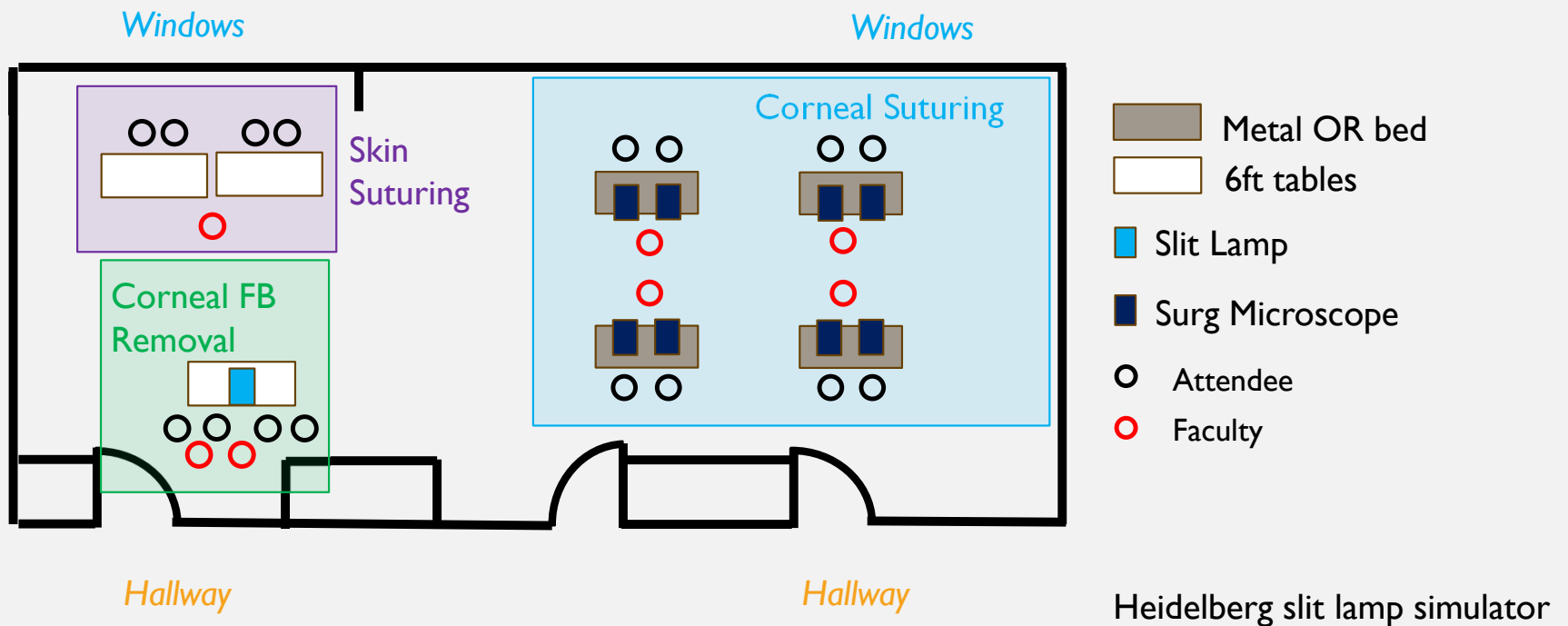

MEDICAL STUDENT WET LAB – CORNEAL SUTURING

Station: Corneal Suturing & Surgical Microscope Handling

- Educational Objectives:
 - Gain experience with microsurgical techniques including corneal suturing
 - Become familiar with the use of surgical microscopes for use in ophthalmic surgery
 - Demonstrate proper handling of surgical instruments used for basic corneal suturing techniques (needle driver, forceps, and scissors) with correct hand positioning and control.
 - Perform at least one basic suturing technique (simple interrupted) on the pig eye with appropriate tension and spacing between stitches.
 - Recognize and correct common errors in suturing technique, such as improper knot tying, uneven tension, or inaccurate needle placement.
- Learning Objectives:
 - Suturing of cornea and ocular tissues; visualization of microsurgical field and tissues using ophthalmic microscopes

Model Used (total needed)

- Pig eyes (32)

Microscopes (total needed)

- Ophthalmic surgical microscopes (or tabletop if necessary) (8)

Reusable supplies (per station/total needed)

- **11 blade (1/8)**
- **Paracentesis blade (1/8)**
- **Curved tier (1/8)**
- **Straight tier (1/8)**
- **Colibri forceps (1/8)**
- **Fine needle holder (1/8)**
- **Vannas scissor (1/8)**

Single use supplies:

- **6-0 nylon (32)**
- **9-0 nylon (32)**
- Viscoelastic (64) or KY jelly
- BSS (32) or normal saline
- Wekcells

MEDICAL STUDENT WET LAB – SKIN SUTURING

Station: Basic skin suturing

- Educational Objectives:
 - Gain experience with microsurgical techniques including skin suturing
 - Demonstrate proper handling of surgical instruments used for basic suturing techniques (needle driver, forceps, and scissors) with correct hand positioning and control.
 - Perform at least one basic suturing technique (simple interrupted) on a simulation model with appropriate tension and spacing between stitches.
 - Recognize and correct common errors in suturing technique, such as improper knot tying, uneven tension, or inaccurate needle placement.

- Learning Objectives:
 - Suturing of skin, soft tissues, and ocular tissues

Model Used (per station/total needed)

- Fake skin for suturing (1/4)

Microscopes

- None

Reusable supplies (per station/total needed)

- **Curved tier (1/4)**
- **Straight tier (1/4)**
- **Adson toothed forceps (1/4)**
- **Fine needle driver (1/4)**
- **Vannas scissor (1/4)**

Single use supplies:

- **6-0 vicryl (32)**

MEDICAL STUDENT WET LAB – CORNEAL FB REMOVAL

Station: Slit Lamp, Corneal FB, and Seidel Testing

- Educational Objectives:
 - Gain an understanding of corneal foreign body removals and approaches for removal
 - Discuss risks of corneal foreign body removal and the potential for a corneal laceration or intraocular foreign body, and the role of seidel testing to assess globe integrity
 - Practice corneal foreign body removal, burring of residual rust, and seidel testing
- Learning Objectives:
 - Corneal foreign body removal, corneal burr for rust removal, and seidel testing

Model Used (total needed)

- Pig eyes (16)

Microscopes

- Slit lamp w digital viewing mechanism (2)

Reusable supplies (per station/total needed)

- **Styrofoam head (1/2)**
- **Wet lab pig eye pins (3/6)**
- **Corneal burr (1/2)**
- **11 blade scalpel (1/2)**
- **Scalpel handle (1/2)**
- **Golfstick (1/2)**

Single use supplies:

- **30g needle (32)**
- Small metallic FB (32)
- Fluorescein strips (32)